



St. Anns Court, Queen Street, Gillingham

Asking Price: £150,000

St. Anns Court, Queen Street, Gillingham, Dorset SP8 4EE

- No Forward Chain
- Spacious Two Bedroom Apartment
- Walking Distance to Town Centre & Train Station
- Single Garage
- Ideal Investment Opportunity
- EPC: C

LOCATION

The North Dorset town of Gillingham offers the amenities of a major town, while retaining all the charm of rural Dorset. The town has a wide range of facilities, including Waitrose & Asda superstores, a doctor's surgery, dental practice, pharmacies, local shops, boutiques and a well-connected railway station. In addition, Gillingham provides a range of well-regarded schools for all ages.

The communication links are excellent: the A303 runs north of the town and a mainline railway station provides services to Salisbury, Andover, Sherborne and Yeovil as well as London Waterloo (2 hours).

DESCRIPTION

A well-presented, first floor apartment being sold with no forward chain.

THE PROPERTY

Accessed via a private entrance, the property is positioned on the first floor and comprises of a generous sitting room, dual aspect kitchen and two well-proportioned bedrooms.

Completing the accommodation is a family bathroom.



Boatwrights
Estate Agents





OUTSIDE

Of great benefit to the property is the single garage with an additional off-road parking space in front.

TENURE

Share of Freehold.

SERVICES

All mains services are connected.

COUNCIL TAX

Dorset Council Tax Band B.

VIEWINGS

Strictly by appointment only via Boatwrights Estate Agents.

01747 213106

sales@boatwrights.co.uk

www.boatwrights.co.uk



GROUND FLOOR
12.7 sq.m. (137 sq.ft.) approx.

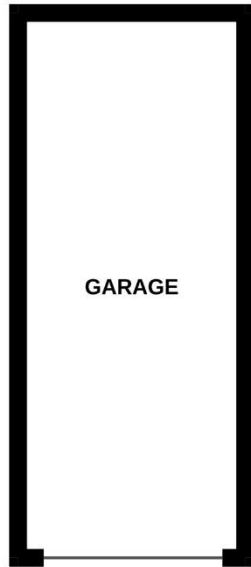

FIRST FLOOR
59.3 sq.m. (638 sq.ft.) approx.

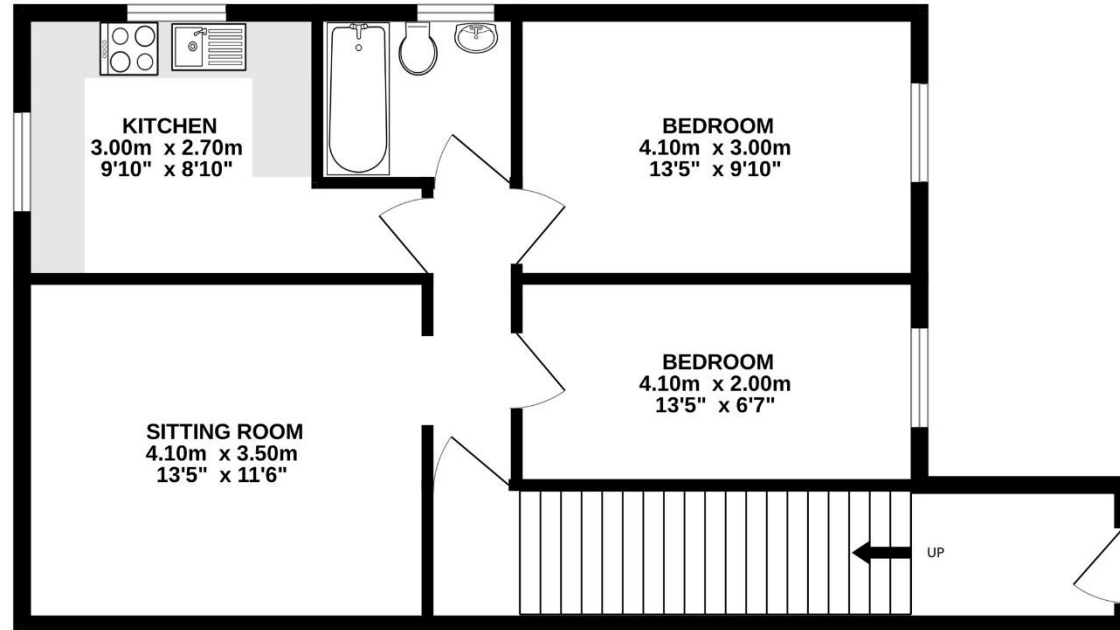

TOTAL FLOOR AREA : 72.0 sq.m. (775 sq.ft.) approx.

Whilst every attempt has been made to ensure the accuracy of the floorplan contained here, measurements of doors, windows, rooms and any other items are approximate and no responsibility is taken for any error, omission or mis-statement. This plan is for illustrative purposes only and should be used as such by any prospective purchaser. The services, systems and appliances shown have not been tested and no guarantee as to their operability or efficiency can be given.

Made with Metropix ©2024



Important Notice

These particulars do not constitute or form part of an offer or contract, nor may they be regarded as representations. All interested parties must themselves verify their accuracy. All measurements and the proportions of the floor plans provided are approximate.

09 September 2024